

FORM No 1.

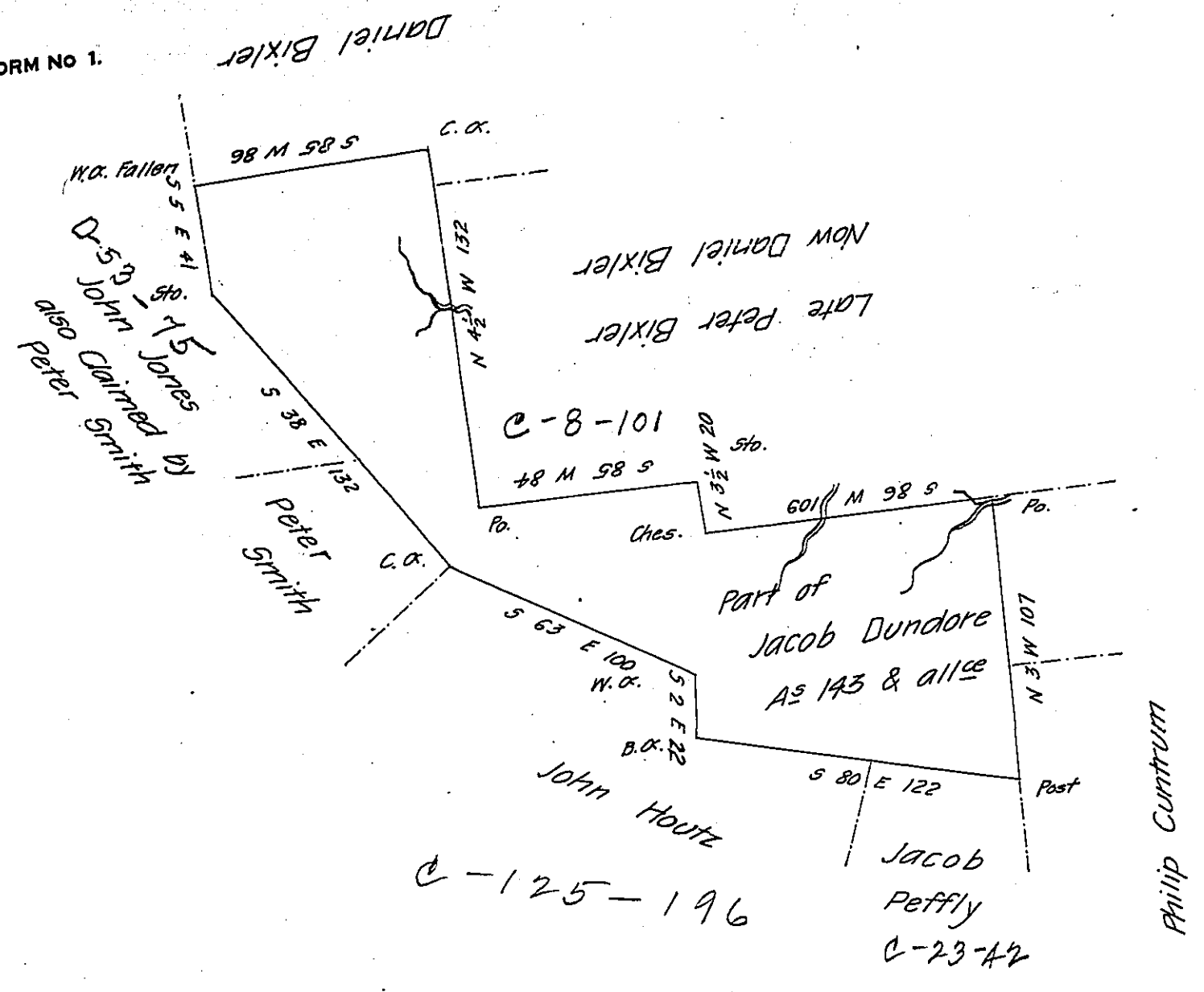

Situate in Bethel Township Berks County Cont. 9 AS 143 & the
 allow^{ce} of 6 P. Cent &^a (Part of a larger tract surveyed to Jacob Dundore
 by virtue of an application No. 1960 dated the 21st October 1766. Resurveyed
 the 7th Nov^r 1808 for the Heirs of Charles Smith deceased
 Henry M. Richards D.S.

To Sam^l Cochran Esq^r
 Sur. Gen^l

IN TESTIMONY that the above is a copy of the original remaining on file in
 the Department of Internal Affairs of Pennsylvania, made
 conformably to an Act of Assembly approved the 16th day of
 February, 1833, I have hereunto set my Hand and caused
 the Seal of said Department to be affixed at Harrisburg,
 this twenty eighth day of May 1908

Henry Houch
 Secretary of Internal Affairs.